

APPLICATION FOR BUILDING PERMIT
Town of Machias, Maine

\$ 35

Building Permit request for:

- New Construction
 Moving of Building
 Conversion to another or different use
 Expansion / Alteration
 Reconstruction
 Replacement

Date application received at Town Office: 1/5/18

Fee Paid \$ 35.00

Recipients Initials: SCP

Name of Applicant:
(or Agent)

Address of Applicant:

Juanine Heald
250 Davis Rd, Alexander Me 04694

Telephone:

Address of Building(s):

Map

Lot

32 Davis Rd, Kennebec Rd, Machias Me 04654
1 44

Proposed Use: (Describe briefly use of structure such as nature of business or residence, single or multi-family)

replace old trailer w/ new trailer on existing pad

Indicate what other structures are located on the same lot and the uses:

existing shed 10x6

(Refer to Town of Machias Building Permit Ordinance 01/26/1989 in answering all applicable sections below.)

1. Yes No N/A A waiver or variance is requested. (Attach separate sheet stating the request and reasons why you believe they should be allowed.)
2. Yes No exists A copy of the applicable town tax map showing lot location is attached. Map 1 Lot 44
3. Yes No The property is connected to the Machias Water Co. supply or can be connected. If the property is not, or cannot be connected to the Machias Water Co. supply, water will be provided by:
 Well Spring Other existing Map 1 Lot 44
4. Yes No The property is connected to Town of Machias sewer system or can be connected. Attach a copy of the Sewer Entrance Permit and include the location of the connection on the site plan if the project is to be connected to the Town of Machias sewer system.
5. Yes No existing A soil test has been conducted for installation of a septic system for sewage disposal. (Attach a copy of test document and diagram of the recommended septic location.)
6. Yes No existing Site plan showing all items listed in section 4A(3) of Machias Building Permit Ordinance is attached. The site plan should reflect the dimensions of the lot on which construction is to be undertaken specifically to include the road frontage measurement. The plan should also include setback distances for the proposed construction from each boundary and from the public road or private access road.
7. Yes No existing A copy of the deed, lease, purchase and sales agreement, or other evidence of ownership or control of the real estate is attached.
8. Yes No Will surface water drainage adversely affect any neighboring properties?
9. Yes No Will lighting reflect beyond lot lines or cause annoyance to neighboring properties?
10. Yes No exists Lot has a minimum of at least 100 feet of frontage on a town road or deeded private way.
11. Yes No exists The building lot is at least 15,000 square feet in size or larger.
12. Yes No exists The building setback will be at least 35 feet from the front of the lot.
13. Yes No exists Side and rear distances from the lot lines are at least 15 feet to proposed building.
14. Yes No The proposed structure will be no more than 50 feet above ground level, including chimneys, stacks or other protrusions that are part of the structure.
15. Yes No There will be safe vehicular entrance and exit to public or private roads that border the lot. (Indicate vehicle driveway on site plan.)
16. Yes No Will the proposed activity involve the installation or change of use of a driveway providing access to a state highway? If so, an entrance permit from the Department of Transportation must be obtained prior to any issuance of permits and attached to this application.
17. There will be existing off street parking spaces as shown in site plan.

18. Commercial, industrial, and residential structures are required to comply with certain federal and/or state minimum standards and regulations

By initialing the items set forth below, the applicant is acknowledging awareness of, and compliance with, any applicable federal and state regulations and has attached copies of all approved permits that may be required. Indicate below which items apply to this building permit application and certify compliance by initialing the appropriate below:

Water Supply	_____	Water Pollution	_____	Flood Hazard Development Permit	_____
Air Pollution	_____	Soil Erosion	_____	Maine DOT Entrance Permit	_____
Shoreland Zoning	_____	Surface Drainage	_____	Sewer Connection Permit	_____
Sewage Pollution	_____	Noise Level	_____	Natural Resources Protection Act Permit	_____
Other	_____				

19. Estimated cost of proposed building or structure(s): \$ replacement of new home 40,000.00

20. Name, address and telephone number of contractor or builder: Coastline Homes, Ellsworth Me
Route 1, 667-0667

21. I have read and understand the Town of Machias Building Permit Ordinance and hereby make application for a permit based on the information contained above and request the Planning Board to act on this application at its next scheduled monthly meeting.

Signature of Applicant: Juanine Heald

NOTE: Although not required, it is recommended that the applicant, or a duly appointed representative attend the meeting at which the application for a Building Permit is to be considered.

For Planning Board use:

Building Permit: Approved Denied By the Planning Board on (Date): _____

Authorized Planning Board Signature: _____

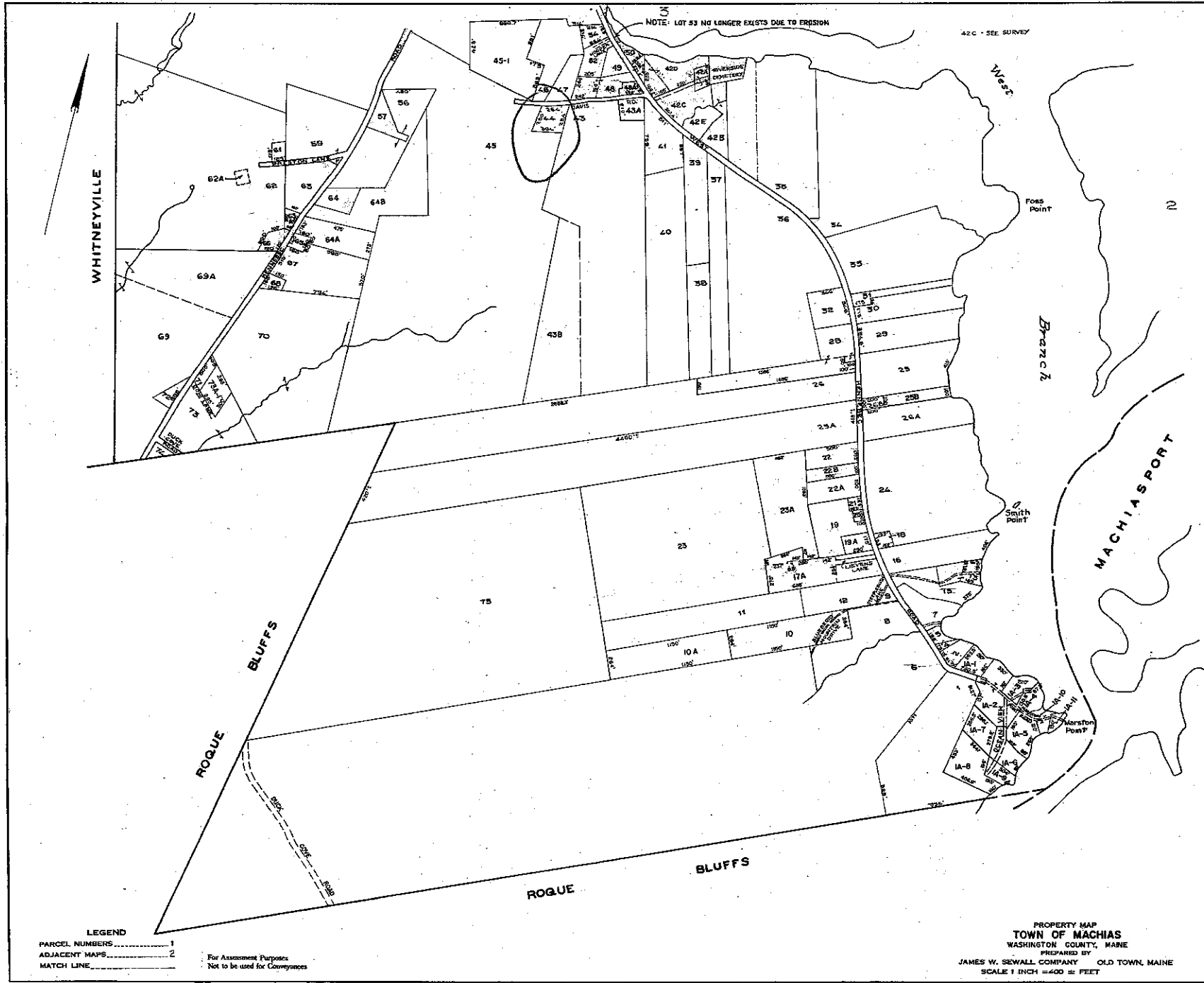

NOTE: LOT 53 NO LONGER EXISTS DUE TO EROSION

42C - SEE SURVEY

WHITNEYVILLE

ROQUE
BLUFFS

ROQUE
BLUFFS

MACHIASPORT

LEGEND
 PARCEL NUMBERS.....1
 ADJACENT MAPS.....2
 MATCH LINE.....

For Assessment Purposes
 Not to be used for Conveyances

PROPERTY MAP
TOWN OF MACHIAS
 WASHINGTON COUNTY, MAINE
 PREPARED BY
 JAMES W. SEWALL COMPANY OLD TOWN, MAINE
 SCALE 1 INCH = 400 FEET