

P10 9-63
 PROPERTY MAP
TOWN OF MACHIAS
 WASHINGTON COUNTY, MAINE
 PREPARED BY
 JAMES W. SEWALL COMPANY
 OLD TOWN
 SCALE 1 INCH = 100 FEET

For Assessment Purposes
 Not to be used for Conveyances

7/0 9-31

SEND
 RS 1
 S 2

SEE MAP 9

MAP 011 Lot 00



PROPOSED 4 UNIT
OFFICE BUILDING 44'x98'

SCHEELY
SAWICK
NO. G. SAWICK
LIC. 265 (1977)

19 spaces

AHLY
NBURG
251 (2010)

FUTURE OFFICE OR
STORAGE BUILDING

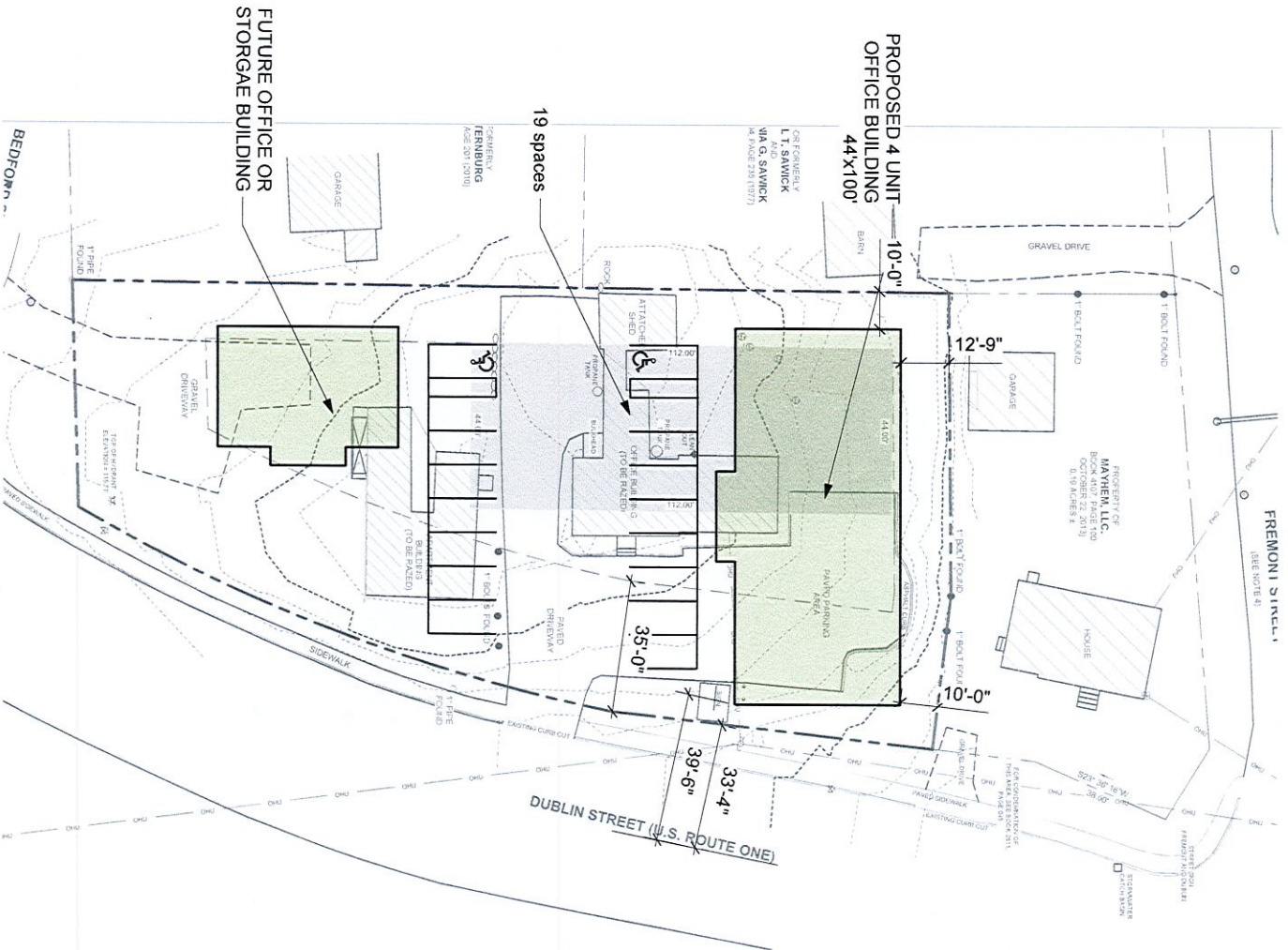

PROPOSED 4 UNIT
OFFICE BUILDING
44'X100'

CONFORMELY
L.P. SAWICK
VIA G. SAWICK
M. PAGE 235 (10/77)

19 spaces

FUTURE OFFICE OR
STORAGE BUILDING

1 SITE PLAN
Scale: 1" = 30 ft